



# Apartment with private forest, water well, climbing wall, spa, dog park, playground, spa, spinning, gym and more for sale Naucalpan

<i>ID: DCM215-7</i>	<i>Location: Mexico City</i>
<i>Zone: Naucalpan</i>	<i>Type: Condos</i>
<i>Bedrooms: 3</i>	<i>Bathrooms: 2.5</i>
<i>Levels: 1</i>	<i>Parking(s): 2</i>









SELVA & Co.  
REALTY

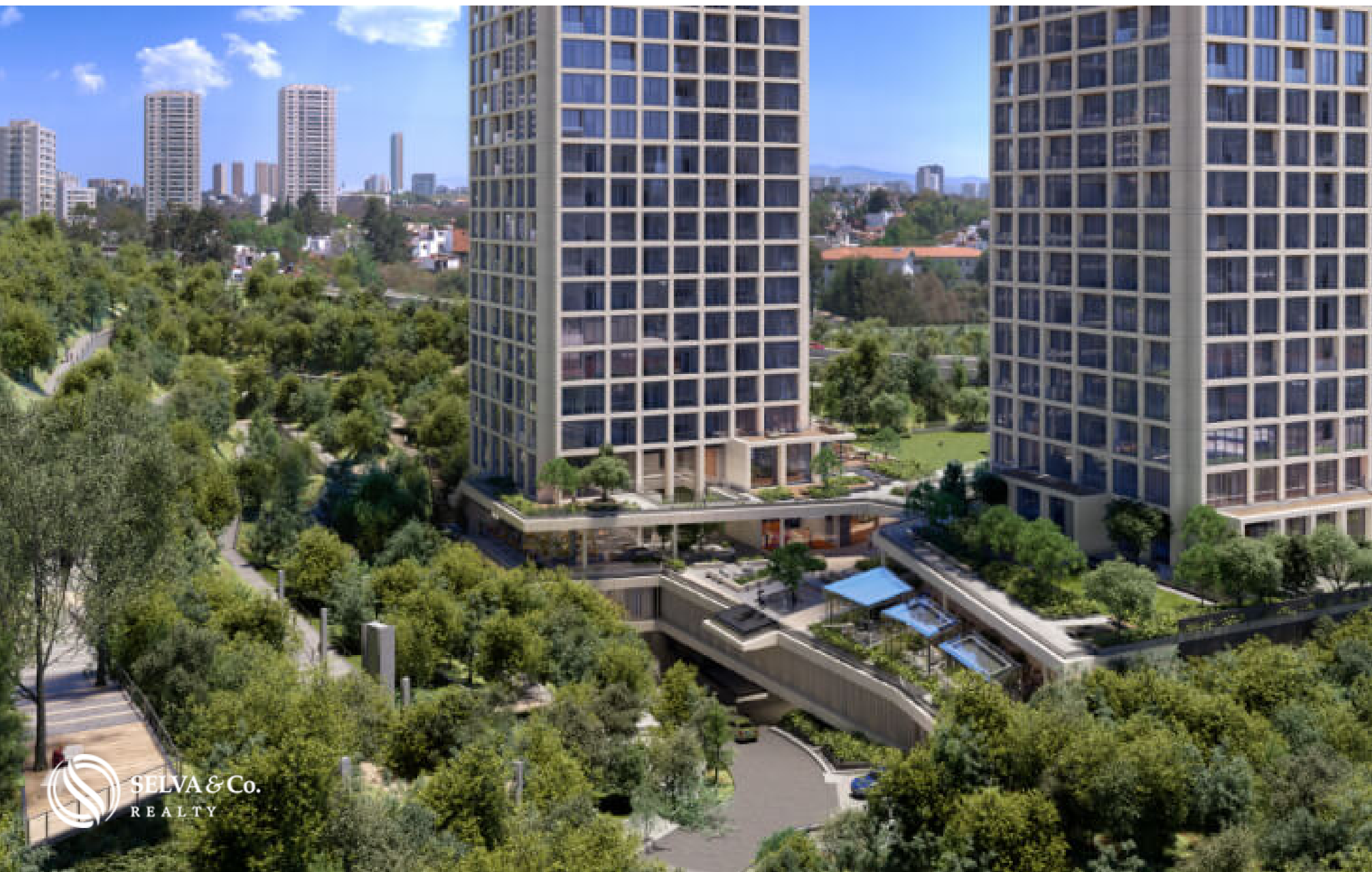









SELVA & Co.  
REALTY





SELVA & Co.  
REALTY



NUOVE IDEE PER IL VOSTRO SPAZIO





## TODOS LOS PUNTOS NECESARIOS A UNOS METROS

- 1 Centro Comercial Interlomas (100 mts)
- 2 Paseo Interlomas (2 km)
- 3 Hospital Ángeles Lomas (2.3 km)
- 4 Central Interlomas Centro Comercial (2.3 km)
- 5 Universidad Anáhuac (200 mts)
- 6 Walmart Lomas Anáhuac (4.5 km)
- 7 Costco (0.9 km)
- 8 City Market (1.1 km)
- 9 Chedraui (100 mts)
- 10 La Comer (650 mts)

## CONECTIVIDAD CON TODA LA CIUDAD

- Ruta Santa Fe
- Ruta Vistahermosa
- Ruta Tecamachalco
- Ruta Bosques

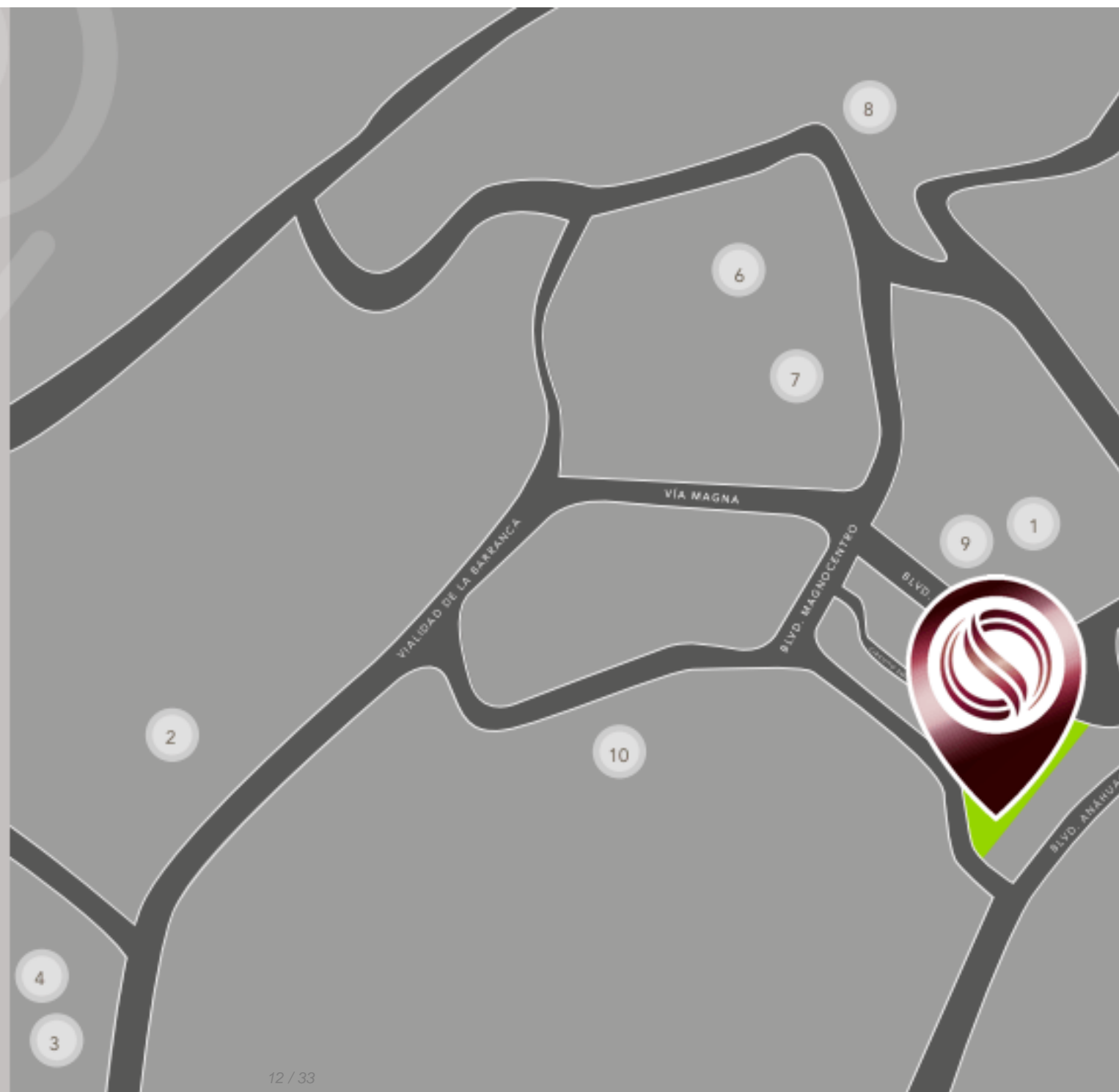







NUA. 02 Características que lo hacen único























NUA. 02 Características que lo hacen único



## Description

DCM215-7

Apartment with private forest, water well, climbing wall, spa, dog park, playground, spa, spinning, gym and more for sale Naucalpan

Live in a residence that has it all, an intelligent building with innovative design and unique technology. In addition, with private forest, and commercial area, you will not leave the development because you will have everything here.

### PRIVATE FOREST

Condominium with 10,000 m2 of private forest with amenities.

### COWORKING AREA

Working from home has never been better, enjoy a quiet space, with internet, ideal for working in a relaxed environment, a space where you can work and connect



with your team without interruption. The best place to make an office at home.

## PET-FRIENDLY

The residential allows pets, and has an exclusive area for your dog to socialize and be free in a controlled and special environment for them. Enjoy your dog park.

## WATERWELL

On the land of this development, it was possible to consolidate the permits to develop a well that belongs to the federation, however, being within the land and with the construction of cisterns by the development, it is one of the few residential areas that will have water guaranteed.

## SHOPPING AREA

The commercial area is the bridge between both towers that allows residents to live together and find basic life services that allow them to enrich their daily experience and that of their guests, such as restaurants, exercise studios, Pet stores and

boutiques

## AMENITIES IN THE FOREST

Outdoor cinema

Climbing wall

Camping area with cabins

Zen zone

Outdoor Yoga

Jogging track

Human chess

Playground

Dog park

## AMENITIES

Swimming pool

Spa with Jacuzzi



Sauna

Co-Working

Toy library

Adult lounge

Youth Hall

Gym

Spinning zone

## ISOLATION

Audio isolation: cellular concrete technology and concrete blocks for perfect sound isolation between departments.

## SMART ELEVATOR

The elevator system learns the routines of residents to optimize energy and time, Smart building. From the moment the resident enters the building, the entire system is notified by choosing the elevator closest to the parking level and resident's

apartment.

## CLOSEST RESIDENTIAL POINT WITH ANAHUAC UNIVERSITY

The University with the most foreigners at the National level. Capital gains in apartments due to constant demand from the University population. Development Shuttle service to the University

## FREE VIEWS

The diagonal position between the two towers means that no window is in opposition, in addition to the fact that its location surrounded by residences guarantees a free view. Constructive terraces with a "windbreak" system, the design of the tower allows the walls to mitigate the wind in order to enjoy the terrace on the highest floors

## COLOR

The pigment designed by Jean Michel Colonnier for the project gives a unique



personality that at sunset highlights a gold with shades of pink and ivory, which is why the iconic color is patented for these Towers.

## HIGHLIGHTS OF THE CONDO

Panoramic views.

Bright apartment with large windows that allow each of the most important spaces to have natural light. Even the bathrooms.

Private parking for 2 or 3 cars. Ask for availability.

## LOCATION

Located in one of the areas with the highest surplus value in the country. Connectivity with the entire city. In the Heart of Tecamachalco, Interlomas, Bosques and Vistahermosa. Surrounded by the 4 most important avenues in the west with 2 main entrances.

49 minutes to CDMX international airport and AIFA.

## INVESTMENT IN PRE-CONSTRUCTION

Department in pre-sale.

If you want more information about the condo or learn more about the real estate market in the Naucalpan area, contact us, it will be a pleasure to advise you on your new investment in the State of Mexico.

The official price of this property is in pesos, the price in dollars is a reference. The exchange rate of the day will be used for the purchase.

Prices may vary subject to availability, capital gains, etc. as it is a pre-construction project. Contact us to send you updated information.

Schedule your appointment to visit the area or call us to answer your questions.

#CDMXBySelvacorealty #CDMXlistings #selvacorealty #selvacorealtyCDMX



#CDMXRealEstate      #investinCDMX      #condoforsaleCDMX  
#CDMXrealestate    #realestateCDMX    #PetFriendlyCondosforsaleCDMX  
#CDMX #CDMXproperties #presalecondosCDMX #preconstructioncondosCDMX

## Property details

- Garden
- Terrace
- Pet friendly

## Amenities

- Didactic Playroom
- Gym
- Movie Theater
- Sauna
- Yoga area
- Elevator
- Jacuzzi
- Pet friendly
- Swimming Pool

## Location







**SELVA & Co.**  
REALTY

MX 984 803 2058 / US 805 308 2900  
[www.selvacorealty.com](http://www.selvacorealty.com)