

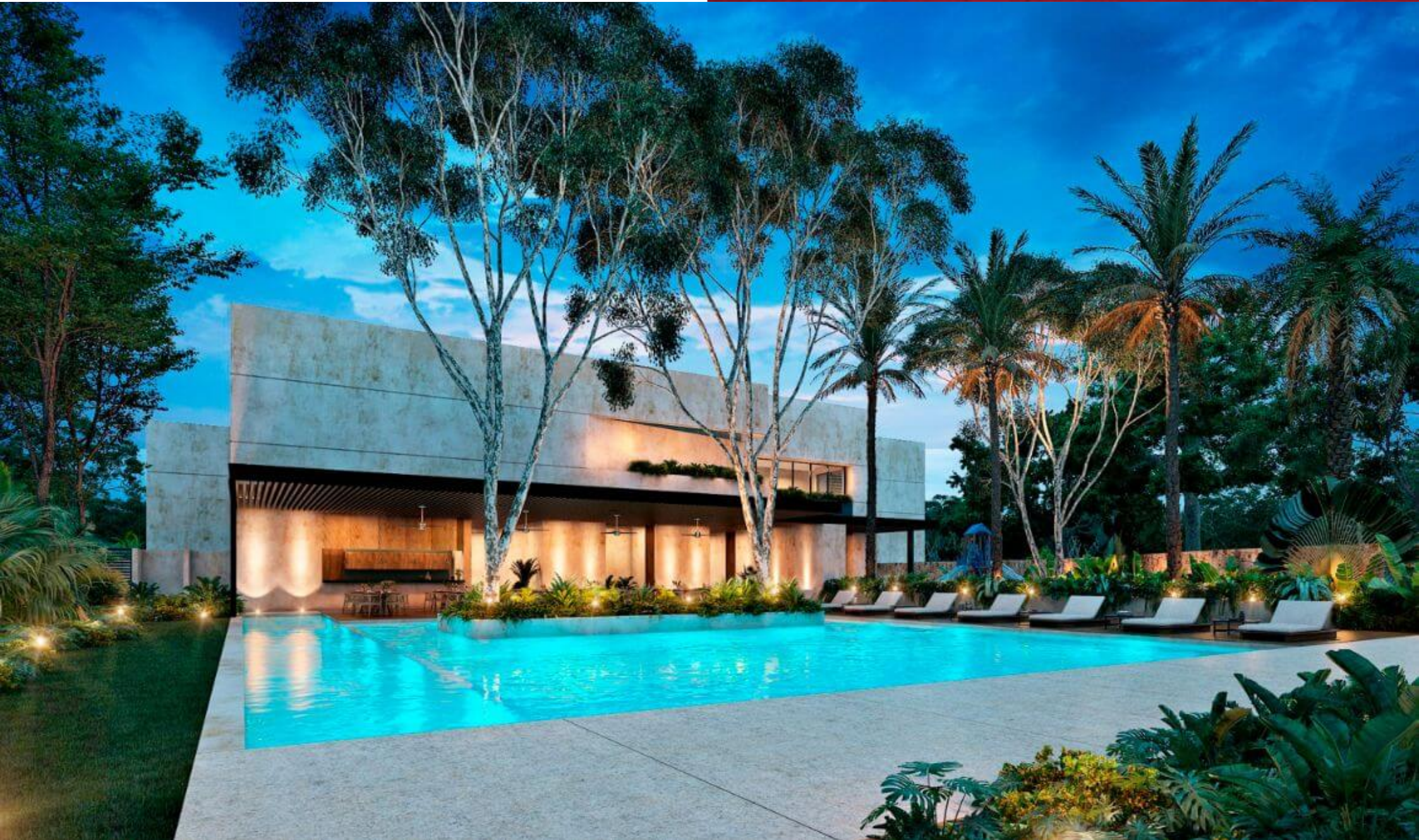

**SELVA & Co.**  
REALTY

[www.selvacorealty.com](http://www.selvacorealty.com)



**Land of 1,042 m2 in a gated community with swimming pool, sports fields, pet park, games, spa, and much more amenities for sale in the North**

<i>ID: DLME200-2</i>	<i>Location: Yucatán</i>
<i>Zone: Merida Progreso Highway</i>	<i>Type: Lots</i>
<i>Land: 600 m2 / 6,458.40 ft</i>	

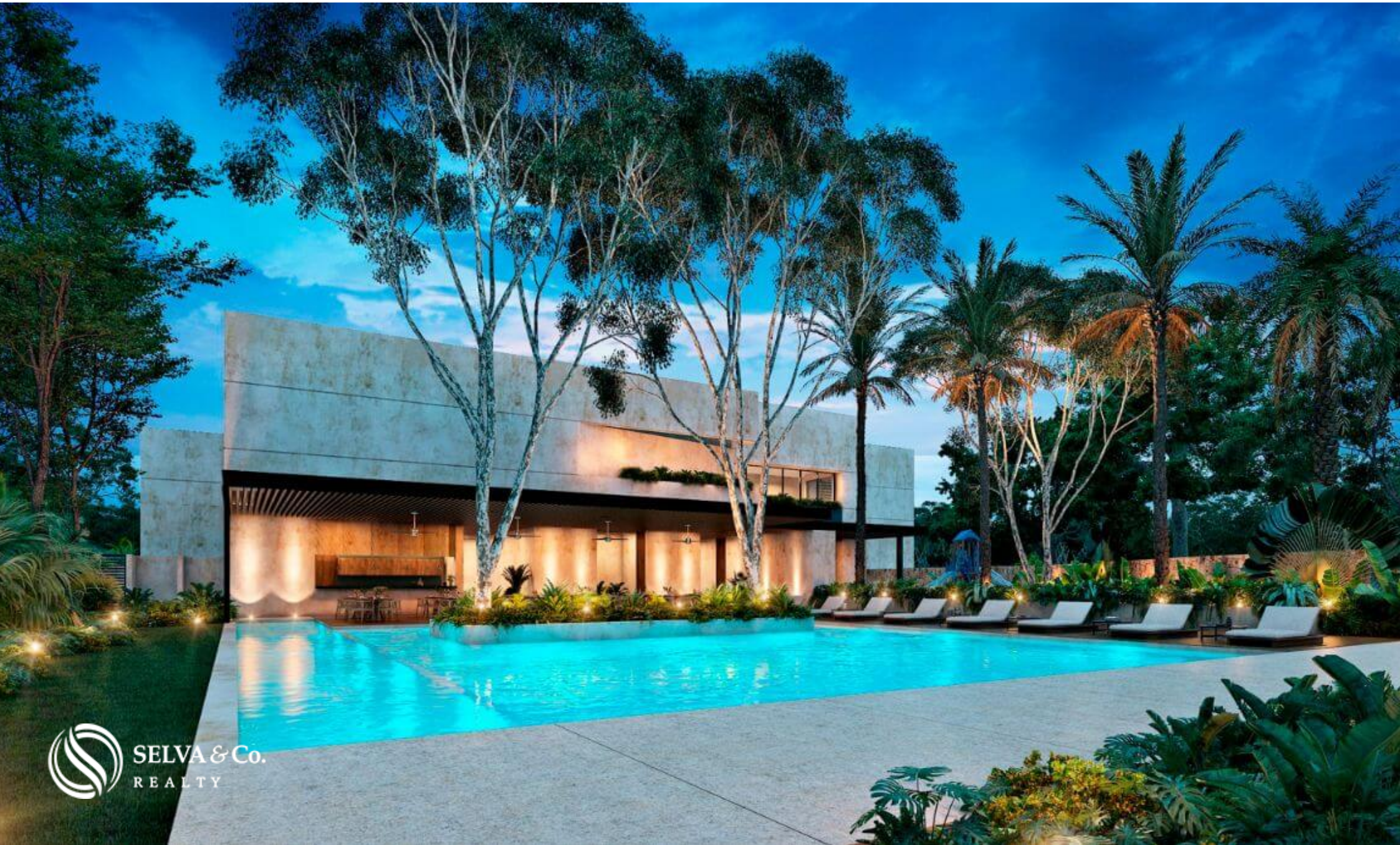

 SELVA & Co.  
REALTY

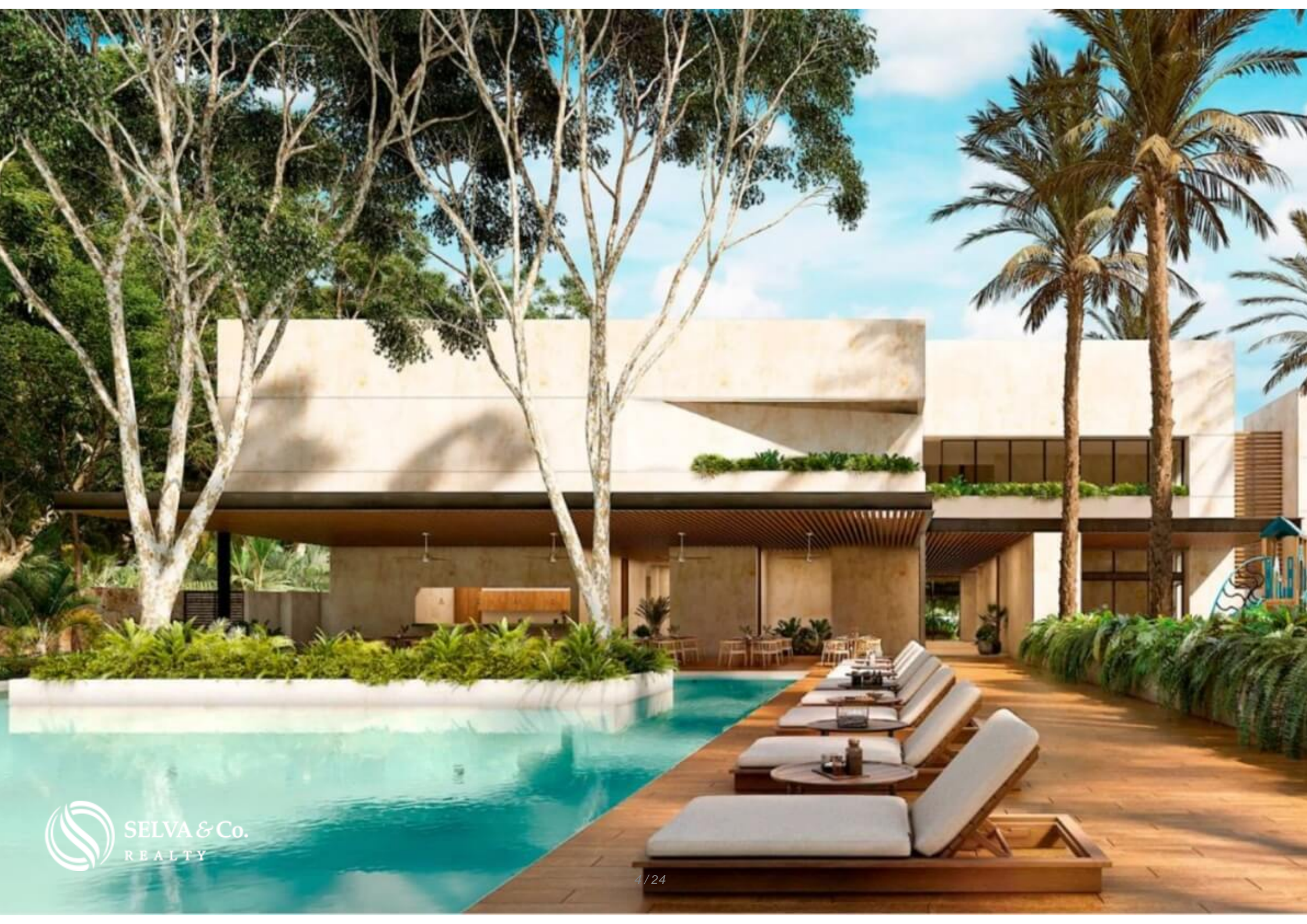



 SELVA & Co.  
REALTY



 SELVA & Co.  
REALTY





 SELVA & Co.  
REALTY







 SELVA & Co.  
REALTY





 SELVA & Co.  
REALTY

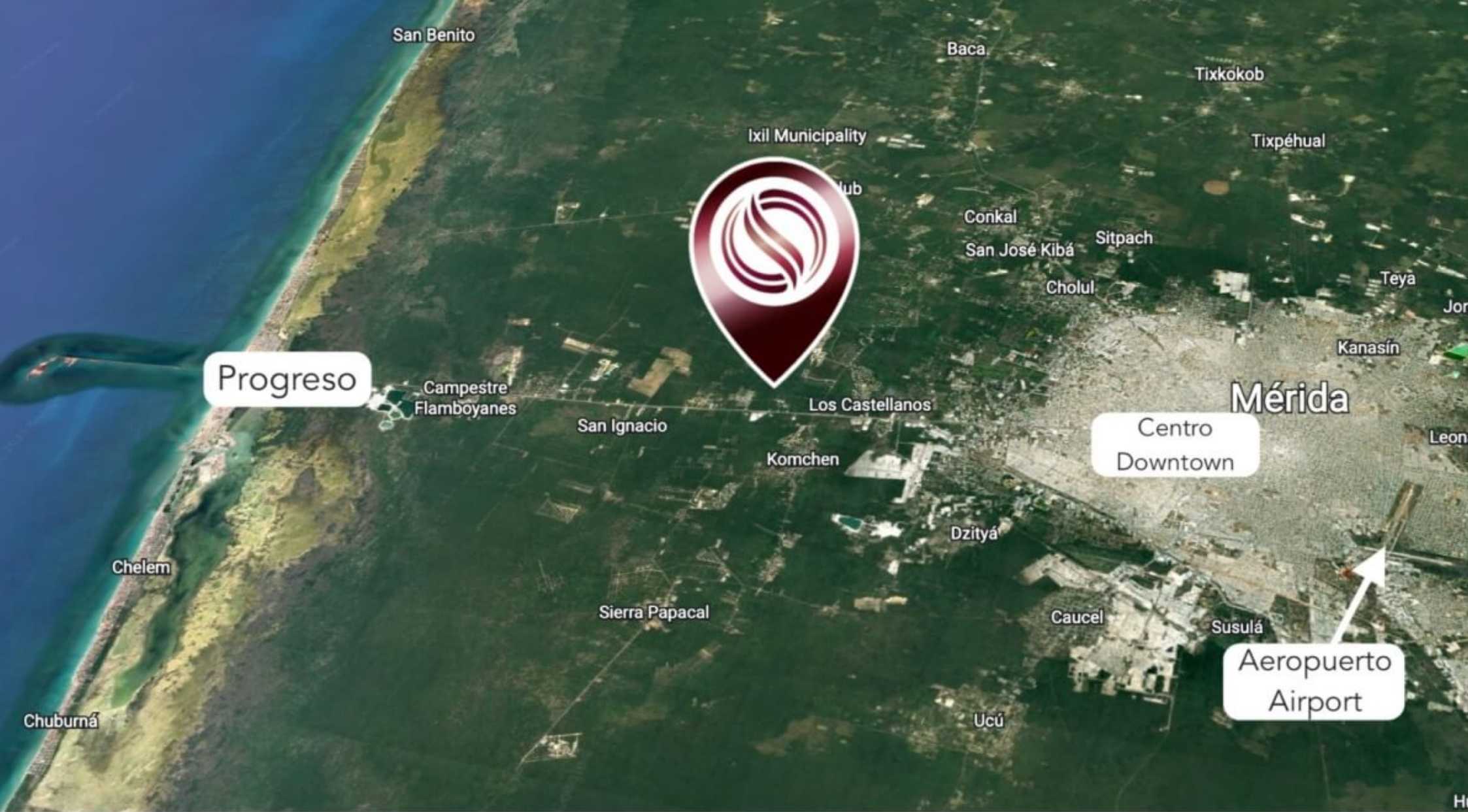

Ubicacion  
Location

## Description

DLME200-2

Residential land with pool, sports courts, pet park, games, spa, and much more amenities for sale North Zone of Merida.

Land in a private community with only 86 residential lots.

The masterplan is designed to live in a comfortable, private and exclusive space. In addition, its personalized amenities and services focus on providing you with better emotional, physical, and social development.

The quality of life for you and your family is a priority.

SPA

Pamper yourself the day you want in an area dedicated entirely to relaxation, a spa with a massage area, steam room, sauna and Jacuzzi. Find total relaxation steps from your residence.

## INDOOR-OUTDOOR LIFESTYLE

Thanks to its multiple outdoor common areas you can enjoy the fresh air all day and decide between sunbathing while you cool off in the pool or enjoying the cool breeze in its shaded area overlooking the garden and/or pool.

## VISITOR PARKING

Visitor Parking - No more worrying about parking your visitors in your

neighbors' parking lots.

## KEEP IN SHAPE

Stay in shape in its pool with swimming lane, practice tennis, basketball or soccer in its sports courts, or simply relax and contemplate its green areas, you will have a different activity to do every day and everything within walking distance of your residence.

## BUSINESS ROOM

Working from home has never been better, enjoy a quiet space, ideal for working in a relaxed environment, or receiving your work team, away from home distractions, at the same time without leaving home.

## PET-FRIENDLY

The residential allows pets, and has an exclusive area for your dog to socialize and be free in a controlled and special environment for them. Enjoy your dog park.

## AMENITIES AND SERVICES

Parking lot

Reception

Cigar Club (Adults Only)

Event Hall

Pool terrace, Restaurant/Snack

Kids club

Pool with swimming lane

Wading pool

Sundeck

Children's play garden

Pet Park

Two Padel courts (One in the Club House and one in the Park)

Half basketball court

Soccer field

Multisport simulator

Business center

Gym

Lockers

Junior's club

Spa / Massage area

Steam and Sauna

## LOCATION

Residential lot located in the North Zone or Merida, ideal location between the ocean and the city.

20 minutes from the beach of Progreso.

29 minutes from Merida Airport.

## RENOWN DEVELOPER

Developer with more projects in Merida, excellent delivery history on time and quality finishes. Widely recommended for investment in pre-construction.

If you want more information about this land or learn more about the real estate market in the North zone, contact us, it will be a pleasure to advise you on your new investment in Merida.

Schedule your appointment to visit the area or call us to answer your questions by clicking on the contact link.

Invest safely, call us to receive a free advice.

#DLME200 #MeridaBySelvacorealty #Meridalistings #selvacorealty  
#selvacorealtyMerida #selvacomercial #investinMerida #Meridarealestate  
#realestateMerida #Merida #landbankingMerida #landbankingmexico  
#landbanking #Meridaproperties #lots&landMerida #lotsforsaleMerida

## Property details

- Garden

- Pet friendly

## Amenities

- Basketball court

- Gym

- Paddle tennis

- Pool for children

- Soccer fields

- Sundeck area

- Tennis court

- Business center

- Kids Club

- Playground for children

- Roof garden

- Spa

- swimming pool

# Location





**SELVA & Co.**  
R E A L T Y

MX 984 803 2058 / US 805 308 2900

[www.selvacorealty.com](http://www.selvacorealty.com)