



SELVA & Co.
REALTY

www.selvacorealty.com



Condo with 7,000 m2 of green areas and amenities, cinema, spa, pool, jacuzzi, and more pre-construction, for sale Santa Fe for sale Mexico C

<i>ID: DCM204-5</i>	<i>Location: Mexico City</i>
<i>Zone: Santa Fe</i>	<i>Type: Condos</i>
<i>Bedrooms: 3</i>	<i>Bathrooms: 3.5</i>
<i>Levels: 1</i>	<i>Parking(s): 2</i>
<i>Construction: 258 m2 / 2,777.11 ft</i>	



 SELVA & Co.
REALTY





 SELVA & Co.
REALTY





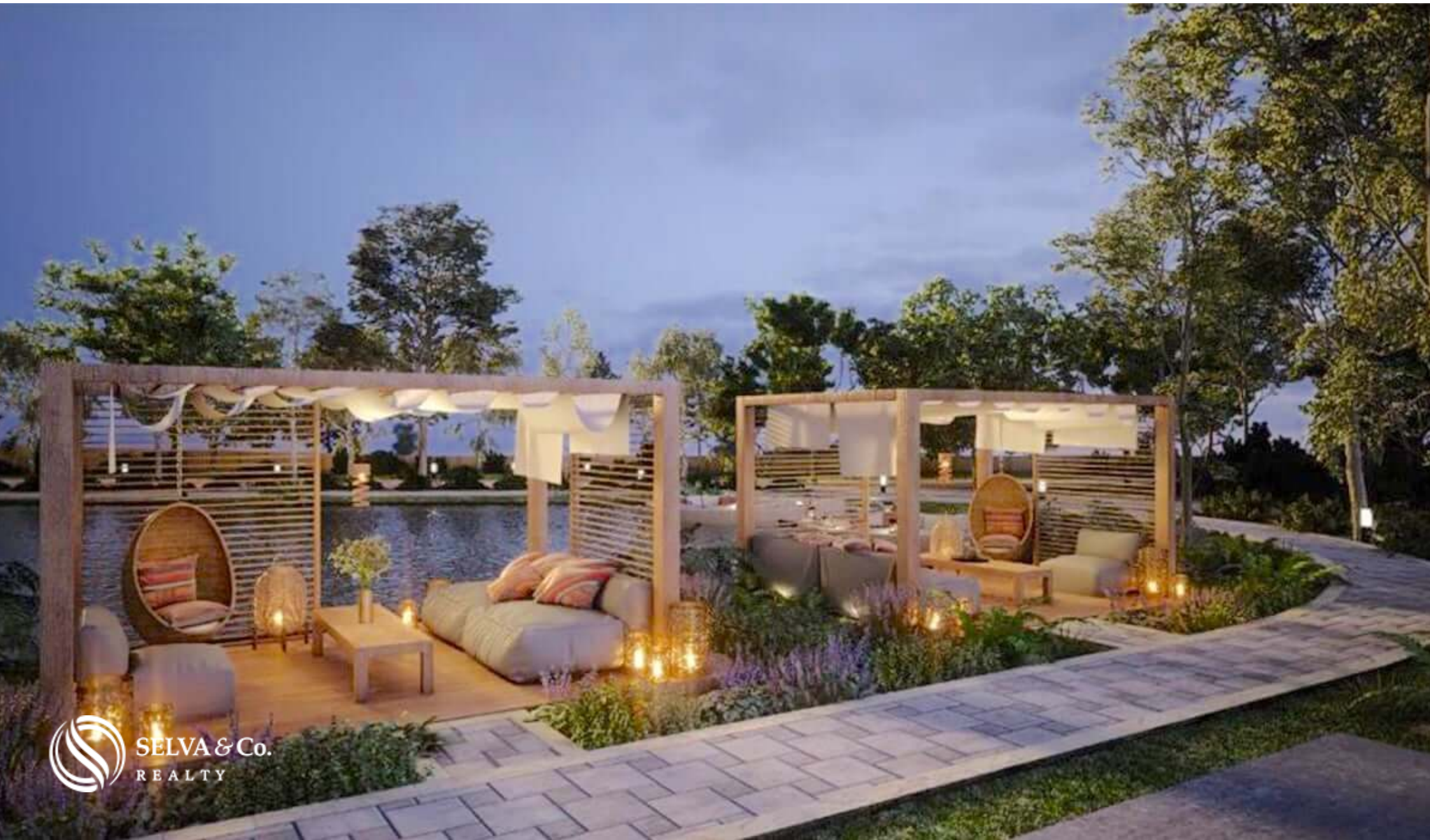

Salon de eventos
Events room







Mini golf



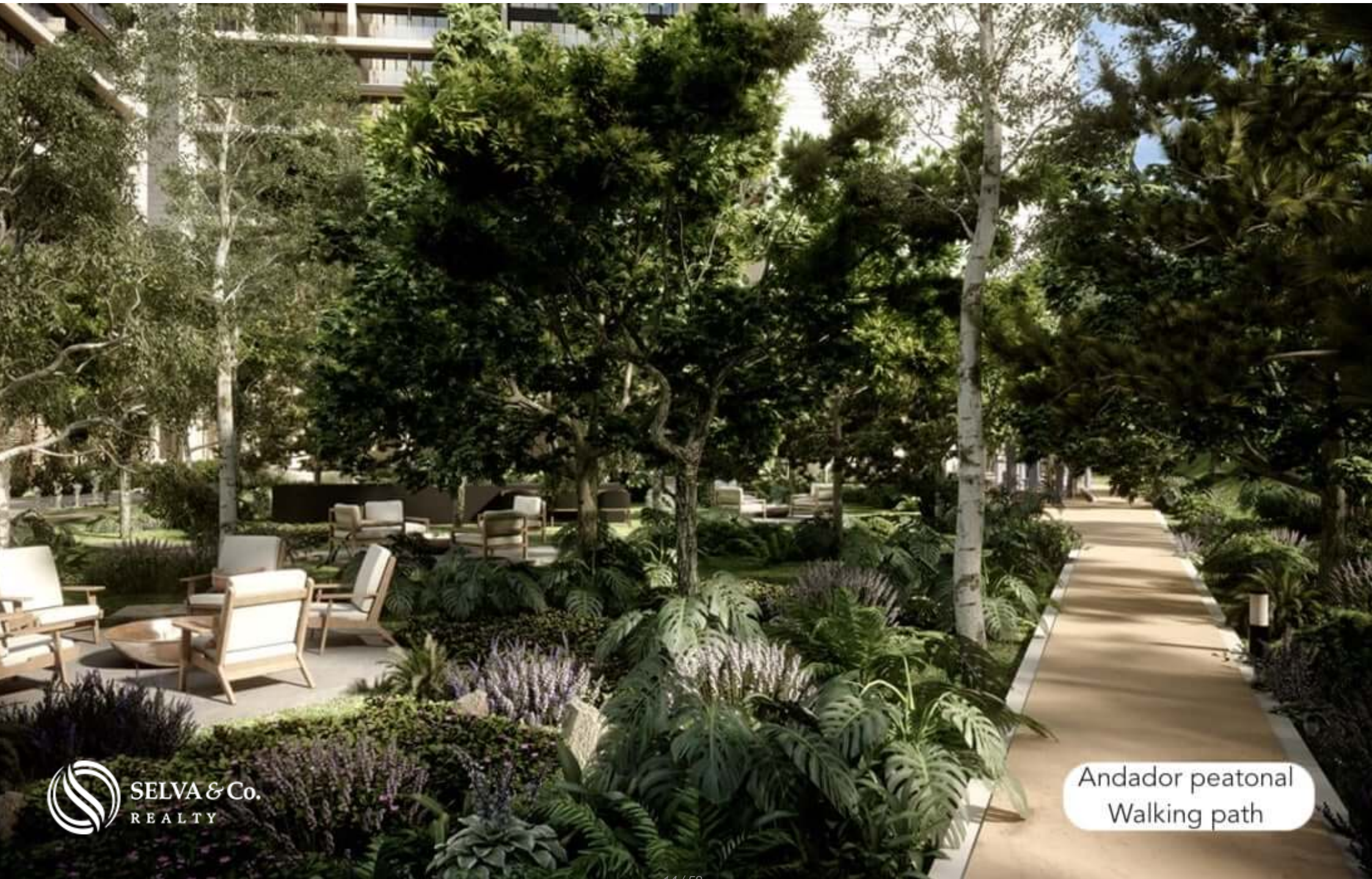

Andador peatonal
Walking path

Area de juvenes
Teens room









Gamer Zone

*LAS IMÁGENES PRESENTADAS SON ILUSTRATIVAS, PUEDEN VARIAR AL PRODUCTO FINAL Y CAMBIAR SIN PREAVISO.

Area de medios

Media room



Kids Place

*LAS IMÁGENES PRESENTADAS SON ILUSTRATIVAS, PUEDEN VARIAR AL PRODUCTO FINAL Y CAMBIAR SIN PREVIO AVISO.

Area para niños

Kids room

19 / 58



Pet Zone

*LAS IMÁGENES PRESENTADAS SON ILUSTRATIVAS, PUEDEN VARIAR AL PRODUCTO FINAL Y CAMBIAR SIN PREVIO AVISO.

PET ZONE



Coworking

LAS IMÁGENES PRESENTADAS SON ILUSTRATIVAS, PUEDEN VARIAR AL PRODUCTO FINAL Y CAMBIAR SIN PREVIO AVISO

COWORKING





VISTAS A AREAS SOCIALES
VIEW TO OUTDOOR COMMON AREAS



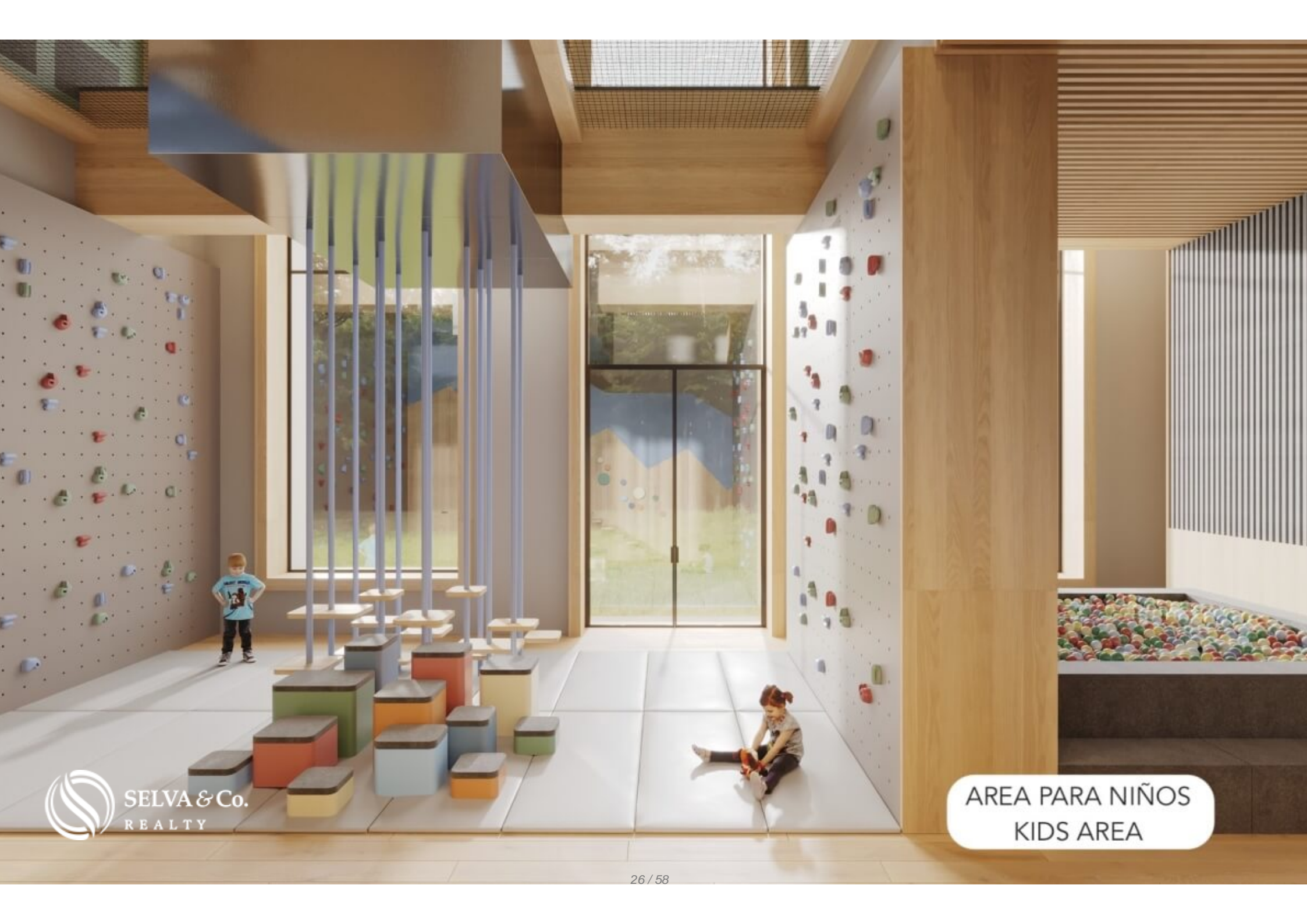

















BAÑO PRINCIPAL

MAIN BATHROOM



BAÑO CON ACABADOS DE LUJO
BATHROOM WITH LUXURY FINISHES



CLOSET VESTIDOR

WALKING CLOSET

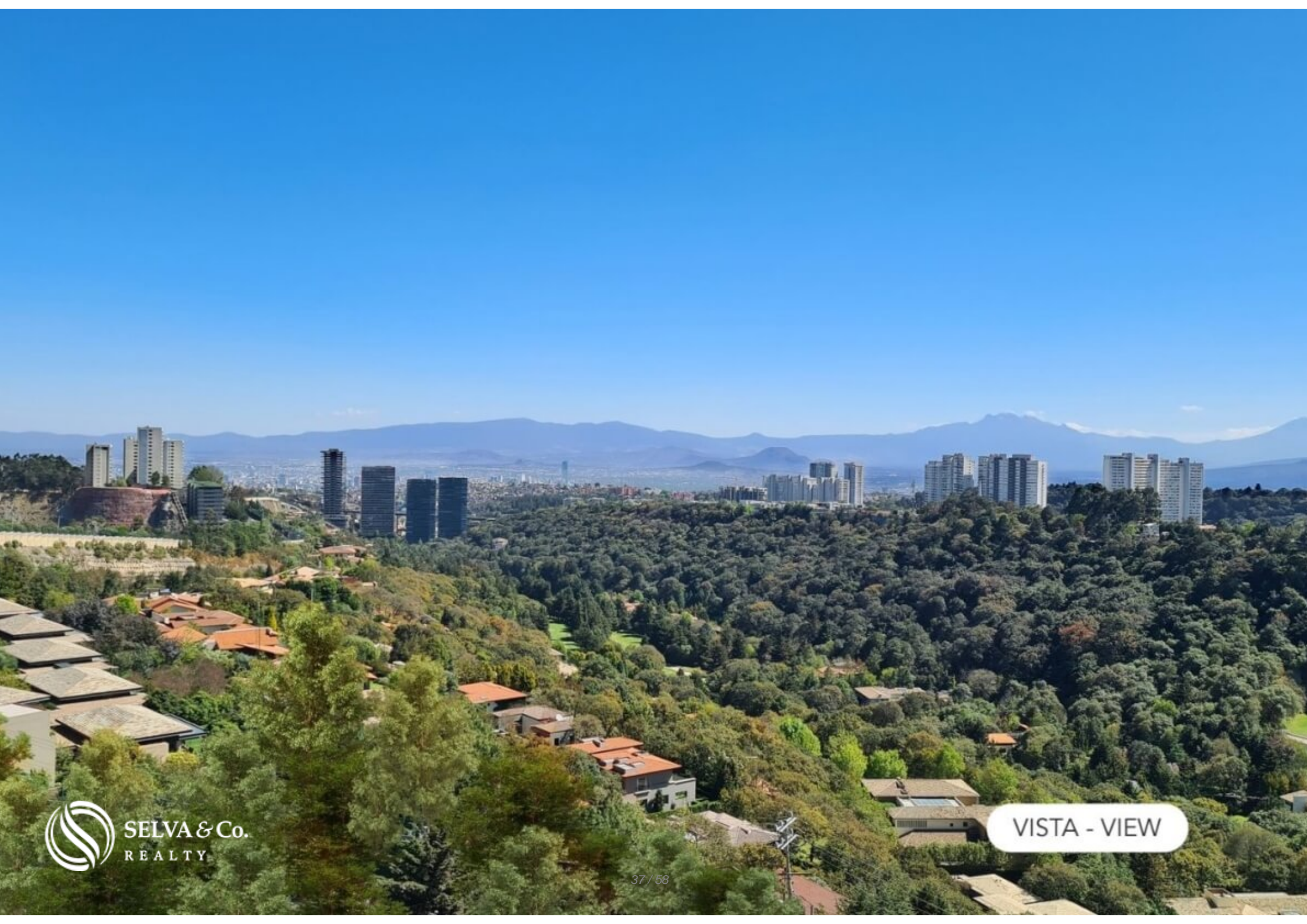



 SELVA & Co.
REALTY





EDIFICIO
RODEADO DE ARBOLES

BUILDING
SURROUNDED BY TREES



Departamento
Condo

La Mexicana

Centro comercial
Santa Fe

Universidad
Iberoamericana

Corporativos

Carrilero
Mexico Toluca

Tec de
Monterrey

Santa Fe es una área cosmopolita diseñada para ser autosuficiente, ya que cuenta con una gran variedad de servicios y atracciones al alcance, es considerada una de las mejores zonas para vivir en la Ciudad de México.

UBICACION

LOCATION

La Mexicana

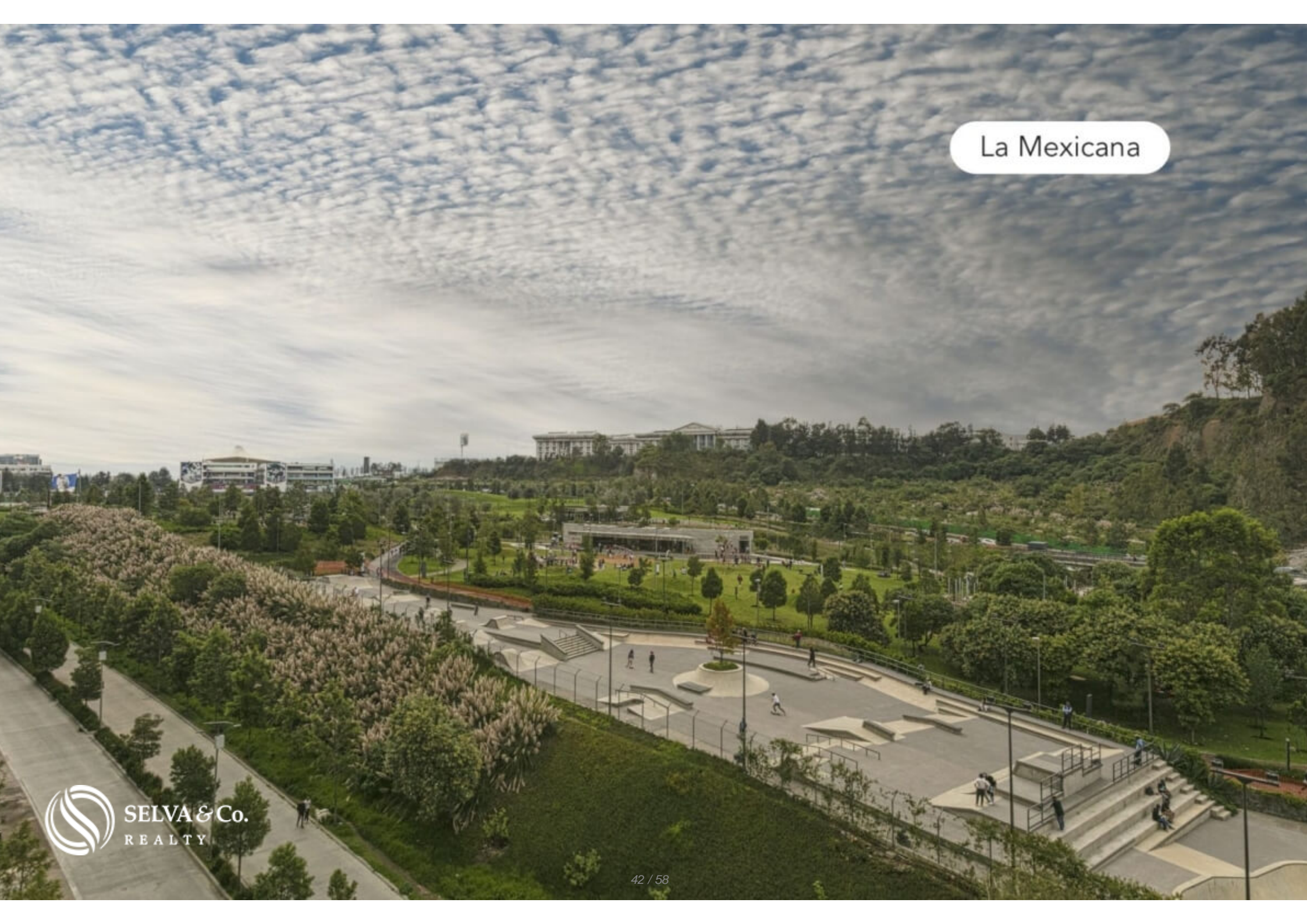

La Mexicana





Description

DCM204-5

Condo with 7,000 m² of green areas and amenities, cinema, spa, pool, jacuzzi, and more pre-construction, for sale Santa Fe for sale Mexico City

Innovative residential concept, with world-class architectural design, green areas that stand out in a notable way compared to other residential in the area, services and unique experiences.

7,000 m² OF GREEN AREAS

With more than 7,000 m² of functional green areas, this development integrates areas of extraordinary experiences that redefine the meaning of coexistence,

comfort, modernity and well-being.

CINEMA

With pay television service and connection to Netflix and Amazon Prime streaming service.

Popcorn service and minibar.

Food service.

PET ZONE

Special area for pets, with store and veterinary.

CONCIERGE

Exclusive concierge assistance service, which distinguishes it from any development by covering your needs in a personalized way, committing to exceeding all expectations to guarantee total satisfaction 365 days a year.

COWORKING AREA

Working from home has never been better, enjoy a quiet space, with internet, ideal for working in a relaxed environment, away from home distractions, at the same time without leaving home.

Indoor and outdoor coworking area. Enjoy a space surrounded by outdoor plants and another more executive in a private environment.

MARKET PLACE

Here you can taste a variety of gourmet foods, while enjoying the architectural beauty and incomparable interior design.

SPA

Pamper yourself the day you want in an area dedicated entirely to relaxation, a spa with a massage area, Jacuzzi. Find total relaxation steps from your residence.

WELLNESS AREA

Gym

Spa

Pool with swimming lane

Sports fields

Jacuzzi

SOCIAL ZONE

Event hall.

Outdoor barbecue area.

Bussiness center

Outdoor lounge areas

Fire pit

Relaxation area

Market-place

FAMILY EXPERIENCES

Mini golf

Kid's play zone

Pet resort

Skate park

Children's area

Area for teenagers

Media room

Obstacle area

Waiting area for school buses

EXPERIENCES FOR ADULTS

Club lounge

Private lounge

Virtual golf

KITCHEN

Prepare the most delicious recipes in this built in kitchen, with custom-made cabinets and natural stone countertops. Enjoy its open design with a breakfast bar, which allows you to spend time with your loved ones while they prepare their favorite dishes.

HIGHLIGHTS OF THE CONDO

Bright apartment with floor to ceiling windows that allow each of the most important

spaces to have an entrance of natural light.

Room with full wall window and panoramic view.

Master bedroom with en-suite bathroom, walk-in closet, ample space.

Private parking for 2 cars.

Service room with full bathroom.

LOCATION

Condominium located in Cuajimalpa, near Santa Fe zone, a cosmopolitan area designed to be self-sufficient, since it has a wide variety of services and attractions within reach, it is considered one of the best areas to live in Mexico City.

5 minutes from La Mexicana park

50 minutes from the Airport.

PLACES NEAR YOUR APARTMENT

Santa Fe Mall

Recreation and sports areas, such as Parque La Mexicana, a 28-hectare green lung.

INVESTMENT IN PRE-CONSTRUCTION

Pre-sale apartments. Delivery date: 2022

If you want more information about this condo or learn more about the real estate market in the Cuajimalpa area, contact us, it will be a pleasure to advise you on your new investment in Mexico City.

Schedule your appointment to visit the area or call us to answer your questions by clicking on the contact link.

Invest safely, call us to receive a free advice.

#DCM204 #MexicoCityBySelvacorealty #SantaFelistings
#MexicoCitylistings #selvacorealty #selvacorealtyMexicoCity
#SantaFeRealEstate #investinMexicoCity #condoforsaleMexicoCity
#lifestyleMexicoCity #liveinMexicoCity #liveMexicoCity #MexicoCityrealestate

#greenrealestate #realestateMexicoCity #condoforsaleMexicoCity
#PetFriendlyCondosforsaleMexicoCity #tMexicoCity #SantaFeMexicoCity
#condoforsaleMexicoCity #MexicoCityproperties #presalecondosMexicoCity
#preconstructioncondosMexicoCity #retireinMexicoCity #secondhomeMexicoCity
#vacationhouseMexicoCity #luxuryrealestatemexico #luxuryrealestateMexicoCity

Property details

- Integral Kitchen
- Pet friendly
- Walking closet
- Panoramic View
- Service room

Amenities

- Ballroom
- Business center
- Jacuzzi
- Movie Theater
- Spa
- Bbq Grill
- Gym
- Lounge Area
- Playground for children
- swimming pool

Location





SELVA & Co.
R E A L T Y

MX 984 803 2058 / US 805 308 2900

www.selvacorealty.com